

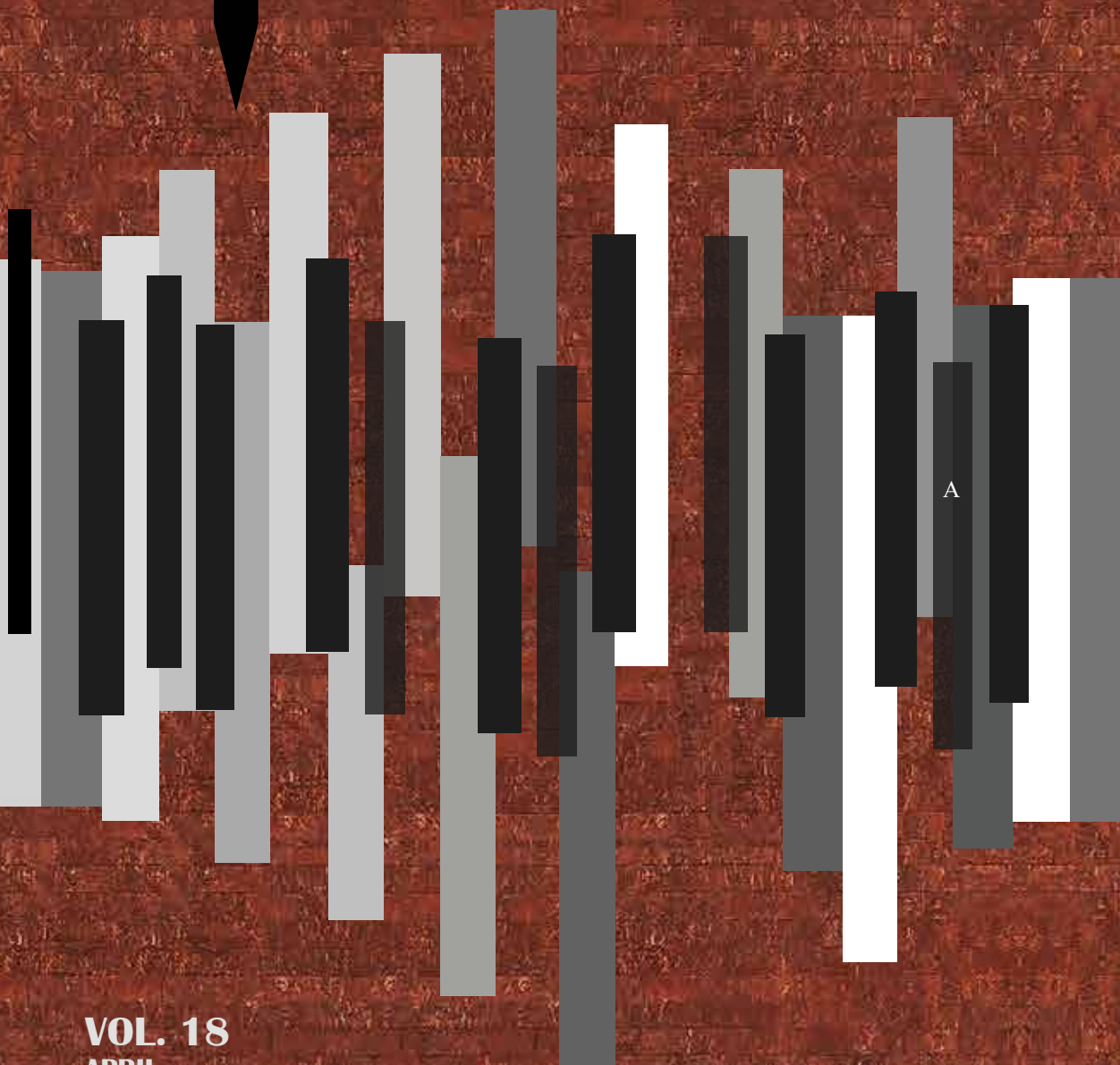

# **DIMENSION** **NEXT**



**VOL. 18**  
**APRIL**  
**2025**



An Architect's life revolves  
around the phenomenon of  
**“ Pin to Piano ”**

From being Visionary to  
translating the Vision



Ar. Ninad Randive  
President

Ar. Ketan Jawdekar  
Secretary

Ar. Suhas Shirgave  
Treasurer

Trustees

Ar. Surat Jadhav  
Ar. Umesh Mane  
Ar. Sreenivas Chundury  
Ar. Sarang Joshi  
Ar. Shrikant Anpat  
Ar. Harshada Naik  
Ar. Ranjit Nikam  
Ar. Amit Oswal  
Ar. Geetanjali Naik  
Ar. Chaitanya Bhurke

ASE 2025 Team

Ar. Gaurav Gajbar  
convener  
Ar. Girish Mhaskar  
Co Convener  
Ar. Shrikant Anpat  
Ar. Sarang Joshi  
Ar. Suhas Shirgave  
Ar. Varsha Guggari  
Ar. Ashish Maldikar  
Ar. Dhairyasheel Powar  
Ar. Girish Pathak  
Ar. Satyajee Jagdale



President's Note



I am thrilled to introduce the 18th edition of our annual magazine 'Dimension Next,' featuring the theme "From Pin to Piano" this theme eloquently illustrates the journey of design, showcasing how even the smallest ideas like a simple pin—can evolve into stunning and harmonious creations, reminiscent of the varied notes on a piano.

This magazine aims to elevate our work within the broader architectural community, both nationally and internationally while inspiring upcoming generations to uphold the high standards established by those who have come before us. Dimension Next serves as a benchmark for creativity, talent, perseverance and dedication.

I extend my heartfelt gratitude to each of you for your enthusiastic contributions to this significant edition, Dimension Next 2025. Your commitment and creativity have truly breathed life into this theme!

This year has been a remarkable year in the journey of e-seed with the launch of the 'Lonar' coffee table book published by The Times of India. With this book the efforts of our e-seed team members are available globally for reference.

The e-seed tradition of organising yearly international tour continues with the Morocco tour in the past year & the Jordan tour this year. Our members have been extensively supporting & enjoying the tours. Another feather in the cap is the first international e-seed event at Dubai this year.

A special shout-out to the editorial team for their unwavering dedication in creating this exceptional publication. Together, let's motivate our readers to appreciate the creative journey, celebrate the elegance of thoughtful design and ignite their passion for architecture and interiors.

President  
Ar. Ninad Randive

Editor's Note



Dear Readers,

In this edition, we explore the theme "Pin to Piano," which highlights the connection between the details of architecture represented by the pin and the artistic expression of the piano. This theme invites us to appreciate how even the smallest design elements can significantly enhance our experience of a space.

We feature a variety of projects, from cozy homes to expansive urban developments. Small-scale designs and Art Installations show how a thoughtful touch can transform everyday living, while larger projects like urban plazas and food malls demonstrate the power of innovative architecture to engage and enrich communities.

Throughout this issue, we celebrate the artistry of architects and designers, who craft their visions with precision and passion. Special Thanks to all who have contributed to this magazine. We hope you find inspiration in these pages. Thank you for joining us on this journey into the lyrical potential of architecture!

Editor  
Ar. Geetanjali Naik

Magazine Trustee  
In charge's Note



Very happy to bring forth Dimension Next 2025, unfolding the essence of design at every scale.

This edition celebrates how architecture and interiors evolve from the smallest details to the grandest structures, proving that design always comes first. Featuring projects of varied scales, from intimate spaces to commercial heights. This issue showcases the versatility, creativity, and impact of thoughtful design.

A heartfelt thank you to our contributors and teams. Specially I thank my editor trustee Ar. Geetanjali Naik and my fellow e-seedians for their contributions. We hope you enjoy this inspiring collection!

Magazine Trustee In Charge  
Ar. Harshada Naik



06

JEEVACHI MUMBAI-  
On the High Sea  
Eseed Annual Social Event 2024

11

NAMSAYA  
Transcending Boundaries  
Ar. Karmavir Ghatge

21

STATUS RESTAURANT-  
Contemporary Dining Space  
Ar. Aishwarya Manade

25

AUDUMBER  
Blend of Indian & Contemporary  
Ar. Ashish Maldikar

34

CEMENT CUBE-  
Minimalism in design  
Ar. Dhanesh Gandhi

FLUTED OFFICE  
Ar. Dhanesh Gandhi

39

WATERFRONT DEVELOPMENT-  
PHD Project  
Dr.Vandana Pusalkar

42

EARLE'S COURT  
A Bright and Artistic Haven for  
Three Generations  
Ar. Pooja Bihani

49

KUSMAVALI WADA  
Traditional Wada Style House  
Ar. Jitendra Bhandari

55

22' x 110' HOUSE  
A Symphony of  
Minimalism & Harmony  
Ar.Tejan Nalawade

RED HOUSE  
Ar.Tejan Nalawade

65

NON STOP IO  
A Playful yet Pragmatic  
Workspace  
Ar. Dhairyasheel Powar

71

GRAND CUBE FOODMALL  
A Vibrant Hub- Offering respite  
& Culinary delight  
Ar. Rafique Momin &  
Ar.Samir Gokhale

77

WIND CHISEL  
Homage to Aviation  
Ar. Minal Khabale

84

WHEN ARCHITECTURE  
MEETS THE LENS  
Ar. Prathamesh Bedekar

90

SWAMI NIWAS -  
A shift in vision  
Ar. Snehal Mane-Paalkar

97

ACE TECH-  
Blum & Astral Installation  
Ar.Gautam & Geetanjali Naik

104

ESEED SKETCHING  
ACTIVITY-  
Late Shrikar Garde  
National Award for  
Excellence in Sketching

107

LONAR COFFEE TABLE  
BOOK ACTIVITY  
Lonar Crater Coservation-A  
legacy of Preservation

110

ESEED ANNUAL TOUR  
MOROCCO:- Friends,  
Acquaintances, Memories,  
Laughter, and Discovery



# JEEVACHI MUMBAI

**ON THE HIGH SEA**  
e-seed **16TH, 17TH & 18TH MARCH' 24**

REPORT BY : Convenor Eseed Convention 2024 :  
Gautam Naik  
Photo Credits : Fame Shutter

Cordelia Cruise:  
Group Picture – 170 Eseedians  
Posing Together



## E-seed Annual Social Event – Jeevachi Mumbai on the high seas - Cordelia 2024

The e-seed Convention 2024 was hosted by the Mumbai team, led by President Ninad Randive and Convention Trustee In charge Ketan Jawadekar, Convenor Gautam Naik, Co-Convenor Kavita Jawdekar, Trustee and Magazine Editor Geetanjali Naik, Nimish Shah.

The event took place on the luxurious Cordelia Cruise, offering a unique offshore experience on the high seas.

### Highlights of the Event

1. 170 Attendees: The 2-day event witnessed 170 e-seed members attending the convention.
2. Conference and Presentations: 11 Brands and 6 e-seed architects made presentations, showcasing their work and expertise.
3. Woman-Centric Magazine Launch: Magazine Editor Geetanjali Naik unveiled the first woman-centric e-seed magazine- DIMENSION NEXT WOMAN Power dedicated to woman architects of e-seed
4. E-seed Anthem Launch: Convenor Gautam Naik revealed the e-seed anthem, lyrics written by him and sung by e-seed member Mandar Apte.
5. Cultural Events and Entertainment: The event saw entertainment and cultural events, specially organized by Cordelia for the e-seed fraternity.

### Post-Event Activities

1. Experience Centre Visit: 50 e-seed members visited the experience centre of brand Colour Coats.

The Cordelia 2024 event was a resounding success, offering a unique experience of Naval Architecture and luxury cruise case study for e-seed members.







Convenor's welcome speech and e-seed anthem reveal



Secretary's speech



E-seed 2024 magazine reveal



President's speech



The convention team standing together along with Trustees on the conference stage



Magazine reveal by e-seed Geetanjali Naik, magazine editor, along side our platinum sponsor brand Samrat Ply and Shrinivas Chandury our e-seed ex-president



Pragesh Khanna felicitating another speaker Dhairyasheel Powar



Entrepreneurs hai him, E-SEEDians hai hum

Mandar Apte, doing the rendition of e-seed anthem at Yash Raj studio



Cast and crew -Actors involved in cultural activity of Cordelia cruise



# NAMSAYA TRANSCENDING BOUNDARIES



Ex-president felicitating Kavita Jawdekar the co-convener



Surat Jadhav the founder trustee admiring the first copy of magazine



President Ninand Randive felicitating one of the speaker's Nimish Shah and committee



E-seed People standing up and cheering the National Anthem



AR. KARMAVIR GHATGE  
(Associate. Rukhsar Rangwala)

KGA ASSOCIATES





In the burgeoning area of Vadodara, Namasya is nestled amongst the upcoming high rise residential buildings enclosed with the beautifully crafted landscape around it.

As the sun rises on the horizon, the day of Nehulji(client) begins with the Munias and parakeets chirping, awaiting their breakfast. During his daily morning routine, he shares the verandah space with these prairie creatures.



Entrance

Brick Masonry Details

Easy to spot on the road this singular ground floor residence stands out with a fusion of exposed brick work and form finished concrete structure creating a captivating blend of robust and docile.

At the intersection of the geomagnetic grid lines and the Vastu chakra stands Namasya, a 6000 sqft residence. The 500 sqft courtyard at the core, is the Brahmasthan—the cosmic centre with an 8'0" wide walkway encircling this sacred space. Like a protective embrace, it links the living spaces, creating a seamless flow. The long tunnel like passages weaving through the residence allows cross ventilation with cooled air, filtered by the trees.







The Glass Screen has designed stain glass in the center done by stain glass artist (Mr. Jatin Patel) in Vadodara.

The foyer gracefully introduces the courtyard through a bespoke stained glass partition crafted by Artisan Jatin Patel from Vadodara. This design element not only adds a touch of artistry but also offers a glimpse into the thoughtfully planned outdoor space. The courtyard itself is a masterclass in understanding and respecting natural light patterns. Shade-loving plants such as ferns, philodendrons, and carnations flourish on the south side, while sun-loving species bloom in the sunlit areas. Some exotic plants have found a perfect home in this cultivated micro-climate, their survival a testament to the harmonious dialogue between architecture and nature.

The Deep Stambh is a monolithic Black marble stone chiseled by sculpture (Deepak Mahakul) in Vadodara. Its a silent water feature that gives a trickling sound in the courtyard.



The living room exudes a formal yet inviting aura, with a striking wooden false ceiling that envelops the space. The expansive East-facing window opens onto the garden, where a white marble sculpture serves as the focal point, creating a tranquil connection to the outdoors. Curated loose furniture from Alankaram and Tectona Grandis, alongside a floor lamp by Manish Maheshwari and a solid white marble egg-shaped center table, complete this refined yet comfortable setting.



A beloved tradition in Gujarati households is the evening ritual of sitting on the 'Jhula' (swing) with a cup of tea. This home features a modern interpretation of the classic design, incorporating green marble and an inlaid yellow Jaisalmer carpet. The Jhula is placed within a space that takes full advantage of the cool, pleasant winds filtered through wind tunnels and the surrounding greenery, making it ideal for intimate gatherings and leisurely conversations. The credenza in the room showcases a striking combination of rosewood, Burma wood, and Kapoor wood, further elevating the room's richness.



A skylit passage connects the dining space to the kitchen, flooding the area with natural light. The kitchen's fresh pista green hue complements the wooden tall units, while the wooden handles feature beautifully wood-burned patterns of Saras cranes, adding a touch of whimsy.

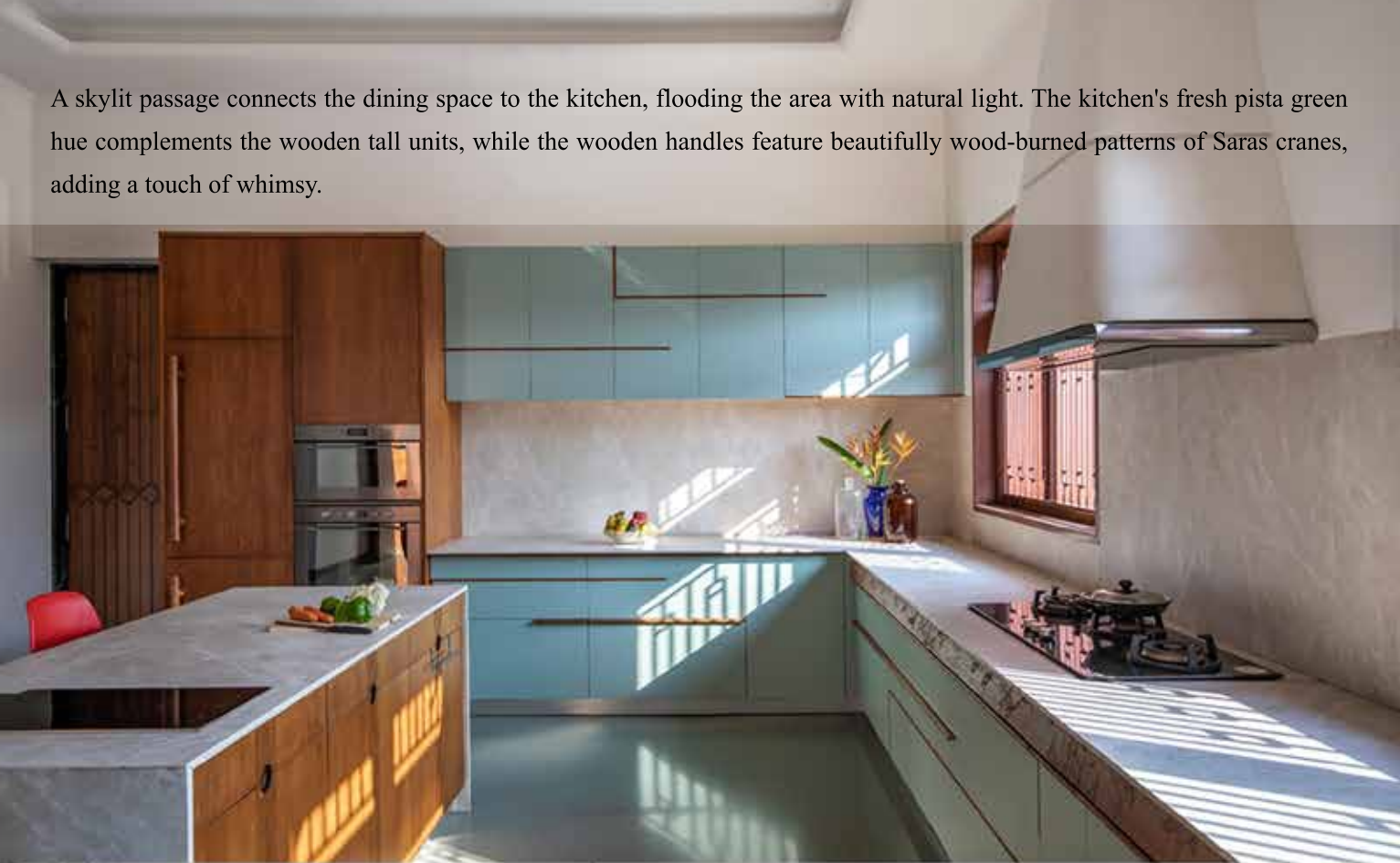

Guest Bedroom with exposed RCC wall as backdrop



The guest bedroom embraces a rustic charm, with a wooden bed that becomes the room's centerpiece. The bed is paired with a form-finished RCC wall, providing a bold backdrop. A daybed from Alankaram is placed by the window, offering the perfect spot to unwind and enjoy the serene courtyard views.



Exposed dining wall with pattern done with double shuttering



Pathway connecting Kitchen and dining with skylight

The dining area provides a seamless transition between the central courtyard, rear verandah, and dining space. A custom-designed stained glass and plain fluted glass light fixture illuminates the dining area, adding a touch of elegance.



The master bedroom radiates warmth, with an intricately designed teak wood bed surrounded by wooden fins that create an intimate, cocoon-like atmosphere. The wooden backdrop is complemented by handwoven wall hangings from THE RUGSTORY, adding texture and depth.





Rug as Artwork . We worked with “The RUG Story” and designed this Rug “**Gulistan**” for the master Bedroom.



Centre table from monolithic white marble (approx. 600 kgs) with a black marble pedestal, handcrafted as designed by local craftsmen of rajasthan (Mr. Tejaram).



Side Table with inlay tops done from Semi-precious stones as per design by the local artist of Udaipur.



Deep Stambh with stepped water feature. Its a silent water feature that gives a trickling sound in the courtyard.



The Garden bathroom, in all its dramatic elegance, is a black and white ensemble, creating a bold and calming environment that offers an intimate, immersive experience.

Powder Room with Turquoise inlay in Australian White marble done by the local sculptors in Udaipur.



Glimpses of Landscape





*With best compliments from :*



**Sathe and Company**

- Modular Kitchen & Home Appliances
- Wall & Floor Tiles / Engineered Marble & Quartz
- Engineered & Laminated Wooden Floorings
- Construction Chemicals & Adhesives
- Sanitaryware / Bath Fittings & Wellness Products
- Plumbing & Hot Water Solutions
- Home Furniture & Lighting Products

Camp : Ashoka Pavillion, 18 Ambedkar Road, Camp, Pune 411 001 | (020) 2613 9792  
www.satheandco.com | enquiry@satheandco.com

# STATUS RESTAURANT

Status restaurant is a contemporary dining space designed to create a harmonious blend between nature and hospitality.



**Ar. Aishwarya Manade**

**AISHWARYA MANADE ARCHITECT**





Restaurant caters to diverse preferences, offering cosy corners for intimate gatherings and vibrant communal spaces for social dining. The goal was to craft an atmosphere where aesthetics and functionality work together to enhance the overall dining experience.

Restaurant’s façade welcomes guests with a muted terracotta sign, surrounded by lush greenery that sets the tone for an organic, nature-inspired experience.

The interior design focuses on an elegant yet warm atmosphere, featuring a rich palette of soft green , roast brown, warm beige creates a restful ambience.

Thoughtfully designed lighting elements, including sculptural pendent lamps and wall sconces add warmth while the metal chandeliers hanging from tree branches lends a storybook charm to the place.



Large windows introduce abundant daylight while fostering a connection to the lush outdoor greenery. Tables sit along the glazed periphery, offering diners the perfect point to observe and experience the indoors and the outdoors in equal measure. Another very important criteria we had to keep in our minds while designing was to customer should have to feel relax The 10 week timeline quantifies the magnitude of brainstorming and workforce. But as said ‘All that’s well ends well’ as it turned out, was an iconic space created in the heart of the food city Kolhapur.







Crafted wooden chairs with upholstered seats ensure ergonomic comfort, From the moment guests step in, they are enveloped in an atmosphere of warmth and sophistication. The layout fosters an effortless flow, allowing guests to enjoy their meals in a comfortable and aesthetically pleasing setting. The space is visually anchored by handcrafted botanical artwork and striking fish paintings.



## Audumbar



## Ar. Ashish Maldikar

JONQUIL DESIGN STUDIO



Hibiscus Flowers

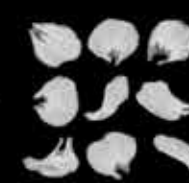

Hibiscus Petals



Front Screen





Project Name: Audumbar  
Size: 8400 Sq.Ft  
Location: Nashik, Maharashtra

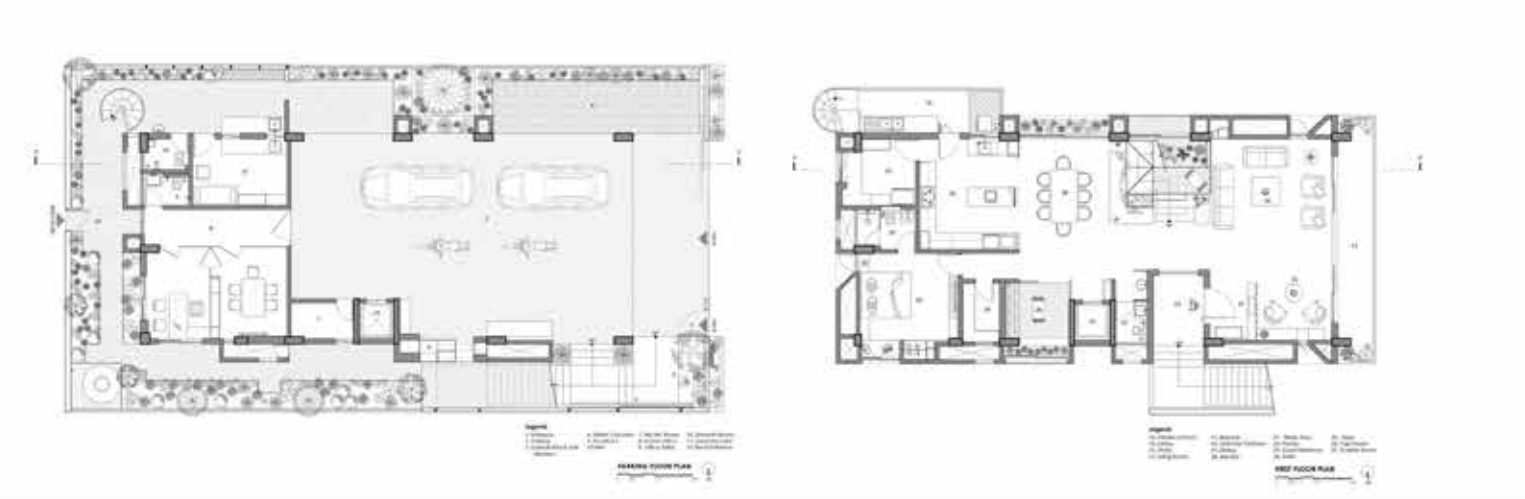

**Concept & Description –**  
Sprawled across four storeys and 8400 sq.ft. this suburban residence is an amalgamation of Indian and contemporary aesthetics, tied together by the flavours of Nashik. Designed by Jonquil Design Studio, this colossal home belongs to a family of six; a family rooted in tradition, one that practices the art of hospitality through the myriad of social spaces interspersed in this transcendent haven.  
Entering from the West, the ground floor houses the parking area, along with the servants' quarters and a home office. This area transforms into a pious place of celebration each year during Datta Jayanti when the family invites devotees for a Maha Pooja. To the north, a water cascade directs you upstairs, to the main entrance of the residence.







Upon entering, you are ushered into the formal living space that opens out into the family space decked out in all white. It culminates into a small balcony on the western end while expanding into the communal spaces on the east. Across is the pooja room, featuring a backdrop of limestones, engraved with shlokas. A screen drawing inspiration from temple musical instruments cocoons it from the main space. The dining room lies next to the pooja room and leads to the navy blue and white kitchen. On the other side, a stepped, basalt platform forms the base of the staircase, lying in the eyeline of the pooja room, reminiscent of the temple ghats. This stepped platform evolved as a space for congregation and celebration, akin to a typical temple katta.

While climbing up the stairs, your vision is drawn upwards, towards vertical lines punctuated by grape leaf impressions on the stairwell wall. Capturing the true essence of its context, the wall is an interpretation of the Nashik vineyards. The second floor houses a courtyard that captures the elements of earth, water and the sun. A brick-laden wall makes its way onto the floor and creates a nook ideal for hosting classical music shows. A pair of insitu benches delineates the performance space. The family room lies just beyond, while the primary bedroom and a guest room complete this floor.



The main bedroom encapsulates the energy of the house. Finished with neutral yet traditional furnishings, it looks out onto the corten steel facade. Outlined in the shape of hibiscus petals, this facade is an important detail that gets better with age as it oxidises, turning into a timeless element that lends this residence its identity. The western sun rays cast a wondrous play of light and shadows into the interiors. This hibiscus-inspired facade acts as the welcoming element to the beholders of the residence, inviting you into this space that celebrates community, craft and culture.

The third floor is home to three bedrooms and a study. The elder son's room emulates a Japandi vibe with light wooden tones and rattan accents. The younger son's bedroom takes on a two-toned theme with brick red accents on a creamy white backdrop. A jharoka-style window peeks into the double-height volume of the musical nook. The three ensuite bedrooms belong to the residents and feature walk-in wardrobes. All have been tailored to the individual tastes of its inhabitants, giving this residence a complex character.





The uppermost floor is a mix of open terraces and enclosed entertainment spaces including a gym, home theatre and saunas. At the front, a bar, a jacuzzi and a terrace lounge invite you for a soulful retreat. A terrazzo outdoor garden acts as an open-air yoga room on the far side. While all the personal spaces have been customised for comfort, it is the focus on common spaces that brings this house to life. The residence is contextualised by the use of local materials and Indian aesthetics. For a residence of this scale, environmental measures are also put in place. Solar panels power more than 80% of the house, with sensor motion lights, low VOC paints and Indian stones used throughout.



This residence weaves a symphony of local flavours through its distinctly designed common and private spaces. The conscious play of volumes welcomes the viewers to explore the house in their own ways. With a focus on creating places of congregation, this house is the epitome of warmth, rootedness and belonging.

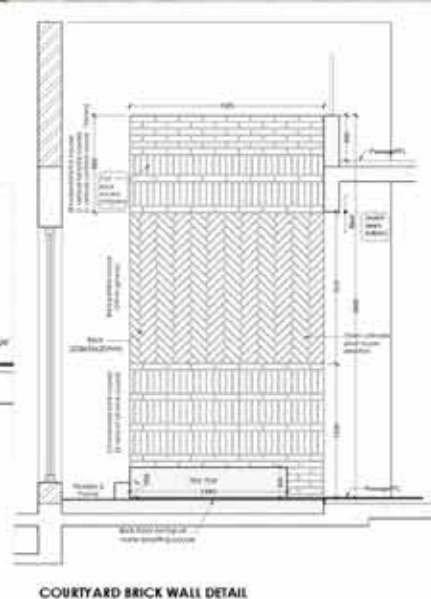
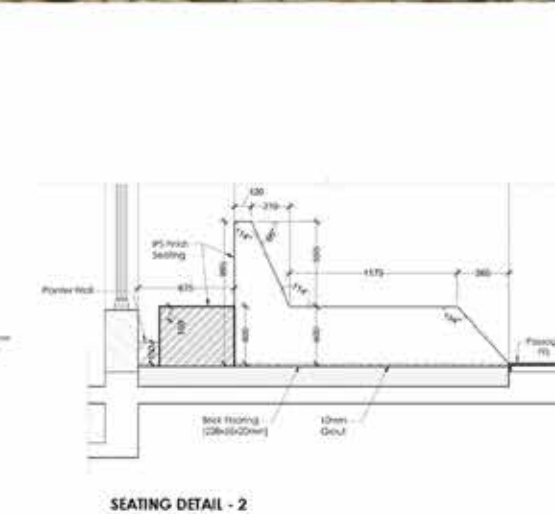
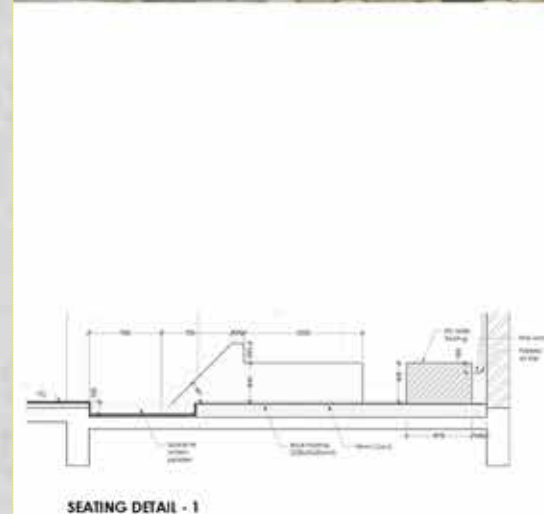





## BEYOND LUXURY, BEYOND EXPECTATIONS



Transforming Design into Inspired Projects.  
Furniture, Decor, Kitchens, Wardrobes, Curated Collaborations & More!



[www.revoluno.com](http://www.revoluno.com) | 9595 808 808

PUNE STORE: VB Capitol, Survey No. 209/1A/2, CTS No. 2709 Bhosale Nagar, Bhamburda, Shivaji Nagar, Pune.  
MUMBAI STORE: 2nd Floor, Chheda Arcade, Swami Vivekananda Road, Khira Nagar, Santacruz (West), Mumbai.



# Cement Cube



Ar. Dhanesh Ghandhi

STUDIO NIRBAADH

Carpet area: 200 sq.ft.  
Location: Kolhapur,  
Photography Credits:  
Ar.Dhanesh Gandhi

The Designed Studio is a small cozy space carved out in such a way that it reflects our design philosophy. The Studio has been designed following a very minimalistic approach towards its interiors. Cement polish becomes the core finishing material of the space commencing from the floor continuing on to the walls and ceiling making the space appear bigger forming a monolithic volume.



Cement polished walls and floor becomes the main character of the space thereby providing a very minimal, earthy and clean look. Leaf impressions on the floor and wall becomes instrumental in accentuating the aesthetics of the space. The Monochromatic space in cement is complimented by wood in the form of furniture and partitions. The Main partition has been designed taking inspiration from the “Golden Ratio” adorned with a small pivoted wooden solid paneled window becoming an eye-catcher.

The table has been elegantly carved out in cement concrete emerging as a monolithic mass from the floor. The Boldness of the cement finished surfaces is balanced by the delicacy and intricacy of the wood. The cold cement finished surfaces are balanced by the warmth of wood thereby creating a subtle ambience and pleasant environment inside.





# Fluted Office

Principal architect –  
Ar.Dhanesh Gandhi & Id.Tanushree  
Gandhi

Firm name – Studio Nirbaadh

Project type – Interior

Project name – Fluted Office

Carpet area – 400 sq.ft.

Project Location –  
Trade Centre, Kolhapur,  
Maharashtra, India.

Photography Credits – Pranit Bora



## Project Description -

The office was initially an empty space which had to be incorporated with a large set of requirements by the client. The proposed space was supposed to have a small waiting area, a receptionist table, staff arrangement for 4 people, 2 individual cabins and abundant storage. Considering all the requirements, we came up with the idea of adorning the entire furniture with the help of flutes which will make it look aesthetically pleasing. The use of flutes became a prominent feature of the space giving us clean lines and a subtle appearance which helped us render its name “Fluted Office”.

The office entrance gets enriched with flutes along with large glass panels admitting light inside as well as wooden pivoted panels allowing the air flow inside. The office tables have been designed to provide a sleek look in the form of a slim table top in laminate/stone and a bold look in the form of fluted boards as the main support. The wooden decorative supports have been provided in addition to give an ornamental look to the space. The storage cupboards have been kept subtle with a nice Matt finish laminate in the common areas and the cabin storage gets embellished with wooden fluted panels and solid wood veneer surfaces. The overall lighting has been kept artful by maximising the indirect lights along with some direct sources from the ceiling. A hanging horizontal task light on the table adds to the beauty of the space.





# Waterfront Development

a Case study of Jayanti River in Kolhapur city,  
Maharashtra, India.



She is CAK alumni of 1996 batch and she has completed her master's in General Architecture, in 2008. She is working as an Associate Professor and Academic Co-ordinator at SPSMBH's College of architecture, Kolhapur, Maharashtra, India

## Dr. Proffessor Vandana Dhaval

A SPECIAL (Social, Physical/Political, Economic, Cultural, Institutional Governance, Adaptive Resilience, and Legal) framework for Sustainable Riverfront Regeneration (SRR).



Dr. Vandana Dhaval Pusalkar has recently completed her doctoral research in architecture (urban design) titled - “Waterfront Development a Case study of Jayanti River in Kolhapur city, Maharashtra, India.” She has completed it on 3rd February, 2025 from Visveswaraya Technological University, Belagavi, Karnataka, India under the guidance of Dr. Vimala Swamy (Professor and Principal, Gopalan School of Architecture and Planning, Bangalore, Chairperson B.O.S. and A.S. Member, V.T.U, Belagavi) and co-guide Prof. Dr Anand Shivpur (Professor, Water and Land Program, Department of Civil Engineering, Visveswaraya Technological University, Belagavi).

Urban riverfront regeneration is a highly debated topic in the field of local planning. This is a result of the organizations' pursuit of innovative leadership and policy objectives. Waterfronts are a crucial element of urban development because they have a significant influence on the image, social equity, and untapped natural resources. Expertise in hydrology, urban planning, environmental ecology, and ecological design is necessary for the development of riverbanks. Conserving the environment is crucial, and engaging in activities along riverbanks can effectively foster social and cultural interactions. Rivers hold cultural significance in Indian civilizations, but their pristine state has become heavily contaminated, undermining their cultural significance. Rapid urbanization has led to pollution, sewage, and contaminated rivers, posing risks to public health and the environment. Urban rivers in India are often polluted, unable to support aquatic life and causing unpleasant odors. River basins hold both geographical and political importance, and sustainable revitalization of waterfront areas should focus on the entire river system.

Kolhapur, a southwestern Maharashtra district, is rich in water, with rivers like the Panchganga and Jayanti flowing through the region. However, the Panchganga has been heavily contaminated for 25 years, and the Jayanti nallah, one of the twelve nallahs, contributes significantly to pollution. The Jayanti River, a major tributary of the Panchganga River, in Kolhapur, is a major source of pollution due to its role in transporting diluted sewage.

The Jayanti River, once a sacred river, has been transformed into a Nallah due to unstructured urban development. The river, once a deity, is now on the brink of extinction due to its lack of aquatic life and biodiversity. The Jayanti riverfront, once a picturesque area, has become a dirty sewage corridor due to negligence and abandonment, threatening the city's urban centre.

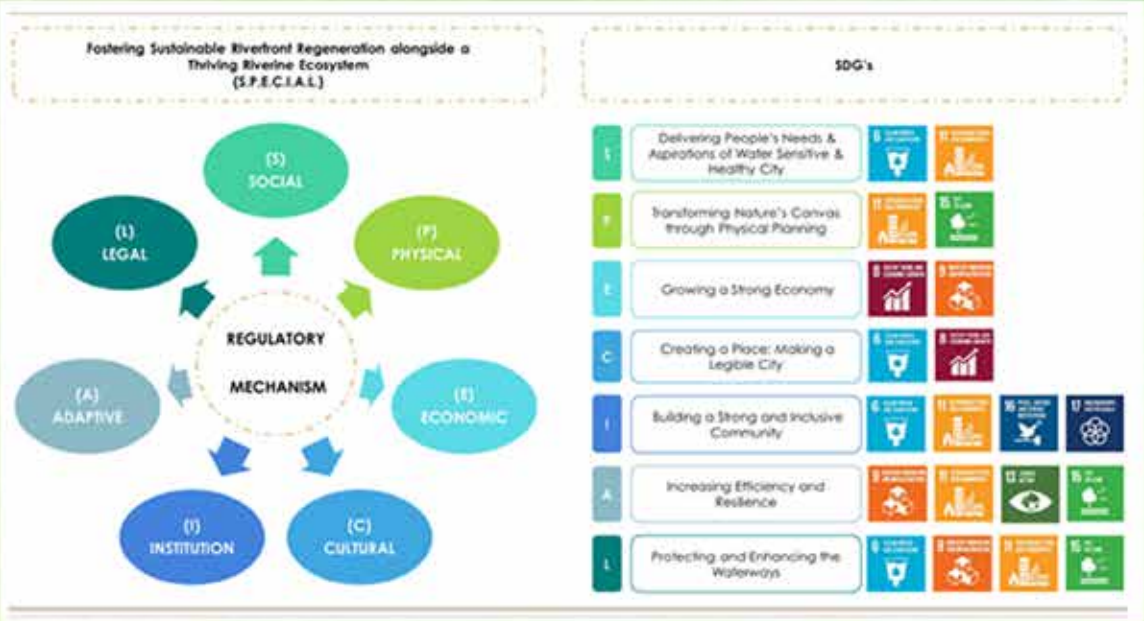

The literature review highlights a significant lack of research on small urban rivers and their activities along their banks, particularly in riverfront areas. There is a lack of comprehensive efforts to address these issues, and there is a lack of established criteria for developing waterfront areas in India. The Ministry of Water Resources, River Development, and Ganga Rejuvenation is aiming to restore polluted tributaries, while Kolhapur's Jayanti River faces degradation. The challenge aims to improve social, economic, and ecological resilience in riverside areas by implementing integrated waterfront management systems, flood safety measures, and technological advancements. This study aims to develop a model for waterfront development and propose sustainable planning-based policies to restore the river's status.

The upstream, upper midstream, and downstream portions of the river, as well as their influence on urban water management, were examined in a thorough case study. This study also examines the Jayanti River's relationship with urban sustainability using back casting approach for future studies. This approach combines the SDGs with the policy framework. It focuses on the historical, current, and future conditions of the river, aiming to create a comprehensive plan for sustainable waterfront regeneration. The study uses the Delphi method to authenticate findings and evaluates the legal and policy framework for achieving sustainable waterfront regeneration.

The Jayanti River, previously known as Jivanti Nadi, is a prime example of this issue. The river's encroachment has led to overflow, flooding, and deteriorating sewer systems. Untreated sewage discharges into the nallahs, causing unhygienic conditions and the spread of disease-carrying insects. The situation is exacerbated by the river's, uncleaning, and unhygienic conditions. The Jayanti Nallah case study highlights the importance of public open spaces in Kolhapur's urban landscape. Despite unclean sewage water, Kolhapur only has 3.5% developed open spaces, below the recommended percentage. Sustainable riverfront development can provide cities and regions with a competitive advantage. Restoring and revitalizing small urban rivers can contribute to urban sustainability. Restoring the nallah and constructing public parks can enhance the river's ecology and preserve cultural heritage sites.

Legal policy framework is developed by formation of a Jayanti River Watershed Development Agency (JRWDA) here at Kolhapur to implement the SPECIAL model. A comprehensive policy framework can be developed to address the issues related to the polluted Jayanti River through riverfront regeneration. Sustainability at the watershed level has been accomplished by implementing the United Nations' Sustainable Development Goals (SDG's). A model called SPECIAL (Social, Physical/Political, Economic, Cultural, Institutional Governance, Adaptive Resilience, and Legal) has been created at the Jayanti Watershed level to effectively combine the Sustainable Development Goals (SDG.s) with the policy framework as shown in chart no.1. Riverfronts connect cities, enhance aesthetics, and optimize urban design and service facilities. Sustainable riverside regeneration balances natural preservation, community engagement, economic opportunities, and cultural heritage. Rivers provide essential water for life, and a thriving urban setting requires decentralized wastewater treatment, local drainage networks, hydrological restoration, pollution reduction, and ecological landscape enhancement.





**Ar. Pooja Bihani**  
SPACES & DESIGN

## Earle's Court

### *A Bright and Artistic Haven for Three Generations*

Area: 3000 sq. ft. duplex residence

Location: Kolkata, India

Date of completion: June 2023

Principal Architect/Designer: Pooja Bihani, Spaces & Design

Design Team: Pooja Bihani, Anjana Chatterjee, Kankana Mitra & Samrat Roy

Photo Credits: Suleiman Merchant

Interior Styling: Samir Wadekar

A tastefully-designed and decorated abode, the Earle's Court is a testament of transformative design.

A remarkable fusion of design elements that have come together to create a bright and artful living space, this is an art lovers haven.

Located on Earle's Street in Kolkata and taking inspiration from the London neighbourhood – Earle's Court – this space has been remodelled for an airy and bright abode that accommodates the needs of a three-generation family.



#### The Brief:

With a fondness for open spaces and luxurious setups, the client wanted a home that maximized floor space along with providing an airy and inviting ambience. This meant creating common areas that are spacious and well-connected, ensuring seamless circulation throughout the residence.

#### Design and Theme:

The design philosophy can be described as "modern yet timeless" as it seeks to infuse contemporary elements with an old-world appeal, creating a living space that exudes both modernity and ageless charm.

To fulfil the client's vision, a muted colour palette full of bright tones was adopted. This meant the incorporation of a lot of whites and light coloured materials such as hand-carved Ash Wood panels, Terracotta Colour Infusions, and Stucco Wall Paint effects. These were chosen to create a sense of depth and richness in the space while the Wicker Totems in the dining area and decorative lights throughout the residence contributed to the eclectic modernism, adding sculptural elements and artistic nuances to the design.







### The USP

The standout feature of the house is the extensive use of hand-carved Ash Wood panels. These panels, present in all common areas, provide a unique backdrop for various settings while also giving the space a more expansive appearance. The intricate carvings on the wood add depth and texture to the design, making them a defining feature.

The flooring in some areas features intricate inlay designs, providing a touch of artistry that elevates the overall appeal. To create a sense of expansiveness, the doors of the rooms are all seamlessly concealed within their respective areas, ensuring an unbroken flow. The marble artistry in the washrooms is a standout feature. The panda marble for the parents' bathroom creates intriguing patterns on the walls and floor, highlighting the play of light and texture.



As you move through the passage and dining areas, you'll notice three standing totems, a creative collaboration with The Wicker Story. These totems are housed within metal cabinets, adding a bespoke and artistic touch to the overall design. The entire residence flows seamlessly, with each room contributing to a light, interesting, and art-inspired atmosphere. This is a perfect fusion of different styles and elements, resulting in a unique and eclectic modern living space.

### The Rooms

A special focus on the design of individual rooms has been made to provide comfort and privacy. In the son's room, a bed takes centre stage, flanked by a study area at the back. This was done to ensure maximum privacy while including a spacious and unique bathroom. The bathroom features separate cubicles for the WC and showers, along with a distinct dressing area. The colour scheme in this room is a striking combination of black and white, reflecting the youthful spirit of the couple. To add an artistic touch, a statement was created on the floor and the walls. The room even boasts a freestanding bathtub that feels like it's straight out of a fairy tale.

The parents' room exudes a sense of simple elegance and regal charm. Muted tones of white, beige, and grey dominate the upholstery and overall colour palette, creating a serene ambiance. The room also has a bathroom adorned with exquisite black and white marble known as panda, which is broken into interesting forms, enhancing the aesthetics of the wall and floor.

On the right-hand side of the passage, is the kids' room. This space comes alive with bespoke wallpaper and furniture. Bright yellows are prominently featured, giving lively and child-friendly ambience while the room's structural columns are cleverly concealed within built-in cabinets.





### The Challenges

One significant challenge in designing this project was dealing with low ceiling height along with the complex structure of the existing building, which was 20-30 years old. To overcome these limitations, we conducted meticulous structural studies and planned the space effectively. This resulted in a seamless, well-connected residence that maximized the available space and ensured a bright and airy atmosphere.



### Conclusion

This vibrant, eclectic living space harmoniously blends unique design elements. The careful selection of materials, a thoughtfully chosen colour palette, and the integration of bespoke elements make this residence a work of art. Overcoming structural challenges, we've managed to transform this space into a testament to the power of design, capturing the essence of its multi-generational occupants' unique lifestyle and character.





# LUXURY REIMAGINED THROUGH YOUR STORY

At Callisto Elements, luxury isn't just a label; it's a personal narrative. Each piece is a reflection of who you are, crafted to tell your story with elegance and sophistication.

CRAFTED IN INDIA

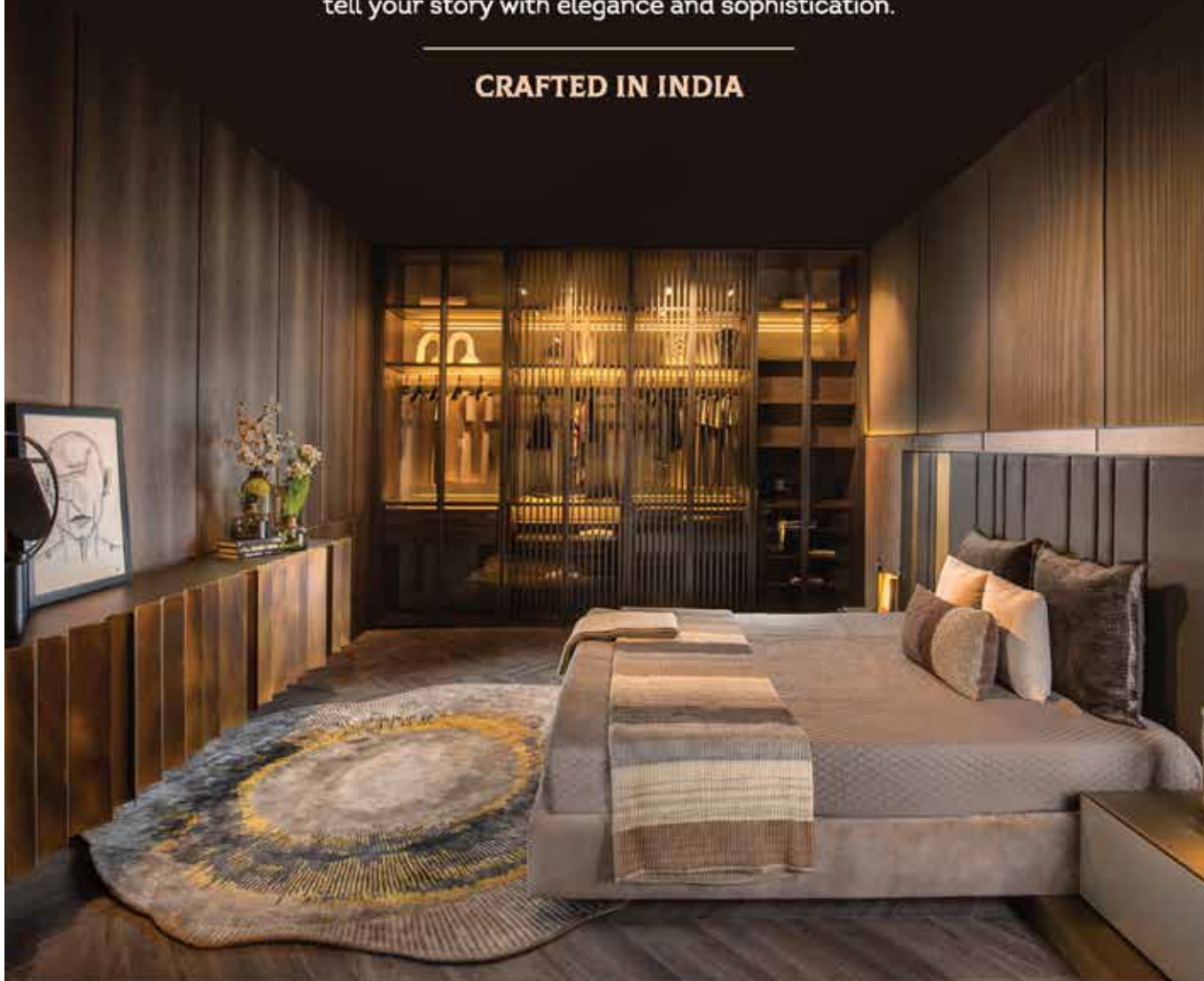

+91 85302 75999 | [info@callistoelements.com](mailto:info@callistoelements.com) | [@callistoelements](https://www.instagram.com/callistoelements)  
[www.callistoelements.com](http://www.callistoelements.com) | Mumbai | Pune | Delhi | Kolkata

## Kusmavali Wada



Ar. Jitendra Bhandari  
PARSHWA ARCHITECTS KARAD



Location - Varunji, Karad.Dist Satara, Maharashtra.

Name of the Firm, Location – Parshwa architects, Karad.

Client – Namdeo Patil & Family.

Scope of Work (Architecture, Interiors & Landscape)

Design Team – Ar. Jitendra Bhandari, Gayatri Vibute – Bhunje, Rakesh Kanthe, Sushant Shedsale .

Contractor – Bhaskar Thorat.

Carpentar – Mr. Shankar Sutar.

Plot Area – 32500.00 Sq.ft, Built Up Area –15,500.00 Sq.ft.

Cost of the Project – 4.5cr

Duration March - 2016 – May 2018.



The site was located in the outskirts of karad, surrounding the green paddy fields around. The adjoining locality was farming sector and the Client too belonged to a Farming family, who has 50 acres of farming in that village and also later developed himself in Political & Real estate sector too. The site which was allotted to us had a existing healthy 5000.00 sqft RCC structure, where they lived.







So the challenge was to cater a design solution for a joint family of three brothers with a requirement of 8 – Bedrooms, 1500 sqft Living room, Swimming pool etc... which would fulfill their requirement of a Lavish House without demolishing the existing structure as they had sentimental values for it.

In the beginning when client approached to us he showed us the reference photographs of some luxury bungalows in Roman and modern style, which wouldn't suit the context around.

Then we suggested them an option which related to the Contemporary Maharashtrian Wada style which would suit their requirements, and was accepted.

A huge foreground was planned in the front of house. A featured Basalt stone masonry arch is designed besides the entrance with a small water body and also Gomukhs are designed from which the water is flowing into the water body, creating a welcoming space at the entrance.



We selected Basalt stone masonry for the house in a contemporary way to give essence of a traditional wada style house. A big Courtyard was planned in the centre of the house, which is the focal point of the planning.

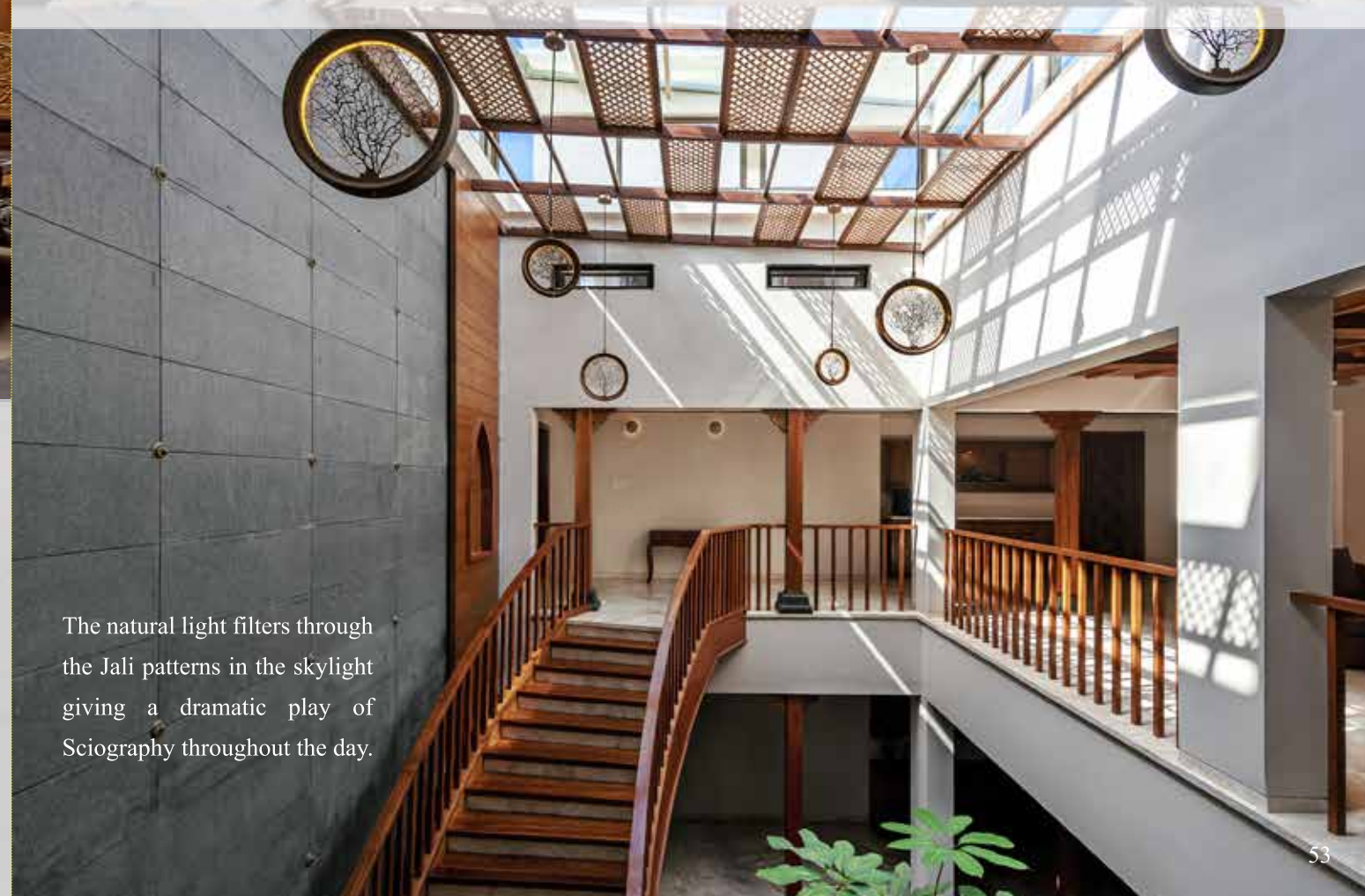

The natural light filters through the Jali patterns in the skylight giving a dramatic play of Sciography throughout the day.





The house was designed in Two floors. Getting inspired from the rich traditional Jali patterns, Wood work & stone work of architecture in Maharashtra, the house gives you the feel of the Maharashtrian Wada. Luxury in a contemporary way. The house is naturally insulated due to the use of Basalt stone masonry used.



The extensions are provided to the main Living areas & the Dining areas, which are semi covered with a use of jali patterns, which create a dramatic play of light.

Skylights are planned to get a balanced light throughout the day. 4 - Bedrooms are provided with Pool side sit-outs to get the cool air from south side. Overall, the entire house is planned to get optimum use of natural light & air.

## 22' x 110' House

*'A Symphony of Minimalism and Harmony'*



**Ar. Tejan Nalavade**  
VISHWAKARMA







Project name - 22' x 110' House

Site Location - Peth Vadgaon, Kolhapur, Maharashtra

Builtup Area - 3300 sq.ft.

Plot area - 4500 sq.ft.

Firm Name - Vishwakarma [https://instagram.com/\\_v\\_i\\_s\\_h\\_w\\_a\\_k\\_a\\_r\\_m\\_a\\_?utm\\_medium=copy\\_link](https://instagram.com/_v_i_s_h_w_a_k_a_r_m_a_?utm_medium=copy_link)

Project Type : Residential

Year of built up - March 2024

Duration of project - 2 years

Project cost - 1.5 cr

Principal Architect - Tejan Nalavade [https://instagram.com/teja3185?utm\\_medium=copy\\_link](https://instagram.com/teja3185?utm_medium=copy_link)

Photography - fameshutter <https://www.instagram.com/fameshutter?igsh=NTc4MTIwNjQ2YQ==>

The "22'x110' House" addresses the constraints of a narrow site with a 22-foot frontage and a 110-foot depth. With neighboring properties in close proximity along the north and south sides, the design became an opportunity to harmonize exterior and interior elements through a refined selection of materials, textures, and colors.







Brick cladding, artfully arranged in a variety of patterns, stands as the project's defining feature. The rich, tactile quality of the brick is exquisitely offset by shades of grey, creating a sophisticated and cohesive visual symphony. Strategically positioned natural light wells, tailored to the home's functional and circulatory needs, introduce a dynamic interplay of light and shadow throughout the day, transforming the interior ambiance into a perpetually evolving experience.







Wall paintings add an extra layer of charm, creating engaging visual elements that captivate and delight occupants in various spaces. The overall design is a testament to the principles of minimalism, meticulously executed with precision and thoughtfulness. By weaving these elements together, the "22'x110' House" achieves a tranquil and harmonious living environment. It underscores the beauty of simplicity, where every element serves both function and form, resulting in a home that epitomizes sophisticated contemporary design.



# RED HOUSE

Project name - RED House

Site Location - Peth Vadgaon, Kolhapur, Maharashtra

Built up Area - 2300 sq.ft.

Plot area - 3000 sq.ft.

Project Type : Residential

Year of built up - October 2024

Duration of project - 1.5 years

Project cost - 1.5 cr



The Red House is a bold yet understated expression of design, defined by its dominating red stone cladding that gives the structure a distinctive identity.

The project embraces a rustic and minimalistic approach, focusing on simplicity in materials, form, and texture to create a timeless and grounded aesthetic.



A key element of the design is the seamless harmony between the exterior and interior, achieved through the use of a consistent color palette and textures. This thoughtful continuity ensures that the spaces feel connected, creating a balanced and cohesive experience.





By integrating minimalism with detailed craftsmanship, the **Red House** exemplifies the idea that simplicity, when paired with thoughtful design, can result in a space that is both sophisticated and meaningful.



Special attention was given to small detailing in both furniture and spatial design, where every element was meticulously crafted to complement the overall aesthetic. These fine details add depth and character, enhancing the functionality and visual appeal of the spaces.



# Non Stop IO: A Playful Yet Pragmatic Workspace



**Ar. Dhairyasheel Powar**  
UNITECTURE





Non Stop IO's office interior, as described, presents a fascinating case study in contemporary workspace design, one that skillfully balances youthful exuberance with practical functionality.

It's a space that understands the evolving needs of a modern workforce, prioritizing flexibility, collaboration, and well-being.



One of the most compelling aspects of this design is its commitment to multi-use furniture.

The reception table that transforms into a mobile bar is a brilliant example of space optimization.

Similarly, the staircase that doubles as an amphitheater demonstrates a keen understanding of how to maximize the utility of architectural elements.

These features are not merely gimmicks; they are integral to creating a dynamic and adaptable workspace.

The office layout encourages both collaboration and individual focus. Open spaces for brainstorming are complemented by cozy nooks for quiet work, catering to diverse work styles.



The inclusion of amenities like a library nook and nap notch underscores a commitment to employee well-being, recognizing the importance of rest and rejuvenation. Furthermore, the integration of nature through indoor plants and natural lighting contributes to a peaceful and calming atmosphere.







The collaborative conference rooms, with their spacious tables and comfortable sofas, are designed to facilitate productive meetings. The emphasis on creating a sense of belonging is evident in the thoughtful integration of private and social spaces. Varied seating options, from ergonomic chairs to lounge areas, ensure that employees can find a comfortable and supportive environment.



The long table that can be divided into two parts is another clever design feature, allowing for flexibility in meeting arrangements. The integration of a vibrant games zone, complete with board games, table tennis, and foosball, provides a creative outlet for employees.

The hammock with a breathtaking view offers a tranquil retreat for relaxation. The seamless epoxy flooring and muted color palette contribute to a calming ambiance, while the exposed services, such as ductwork and cable trays, add an industrial-chic aesthetic.

In conclusion, Non Stop IO's office interior is a testament to the power of thoughtful design. It successfully integrates playful elements with practical functionality, creating a workspace that is both inspiring and efficient.

The emphasis on multi-use furniture, natural light, collaboration, and employee well-being demonstrates a deep understanding of the needs of a modern workforce.

This office is not just a place to work; it's a space designed to foster creativity, collaboration, and a sense of belonging. It effectively navigates the tightrope walk between youthful energy and professional productivity.







**Kolhapur Showroom :** 250 B / 52,  
Opp. Shri Shahu Blood Bank,  
Nagala Park, Kolhapur-416003.  
Mobile : 9822066111, 9922088111.

**Shiroli Branch :** Opp. Hotel Shivtara,  
Kolhapur-Sangli Road, Shiroli,  
Dist. : Kolhapur-416122.  
Mobile : 9922556111, 8830730044.

E mail : chandwaniceramics11@gmail.com Website : www.chandwaniceramics.com

# Grand Cube Foodmall

*A Vibrant Hub,  
offering respite and culinary delight*



**Ar. Rafiq Momin and Ar. Samir Gokhale**

SRUJAN INTERIORS AND ARCHITECTS PVT.LTD



Total Area: 1,00,000 sq.ft

Location: Mumbai-Pune

Expressway khalapur

Time period: Nov 2016- Aug 2019



Nestled strategically near a bustling expressway, the Food Mall emerges as a captivating architectural marvel that seamlessly merges the charm of an airport facility with the timeless elegance of brick cladding.

This contemporary edifice stands as a vibrant hub, offering respite and culinary delight to travellers and locals alike.

The facade serves as a visual symphony, showcasing a dynamic interplay between expansive glass panels and the rich texture of brick cladding.

Surrounded by carefully landscaped greenery, the Food Mall provides a serene oasis amidst the hustle and bustle of the nearby expressway.

The airport-inspired aesthetics and the inviting brick-clad facade create an architectural masterpiece that not only caters to culinary desires but also offers a respite where patrons can embark on a sensory journey that transcends the ordinary.







Stepping inside, visitors are greeted by an awe-inspiring atrium with the soaring ceilings, adorned with suspended light fixtures resembling gentle flight paths, creating a sense of vastness and openness.



Various food stalls, each with its unique culinary offering, line the interior pathways, enticing patrons with aromatic delicacies. Communal seating areas, designed with contemporary furnishings and accents, provide a comfortable and inviting space for diners to indulge in their gastronomic pursuits.







# WIND CHISEL

Homage to aviation.



Ar. Minal Khabale  
DHI ARCHITECTURE & INTERIORS





Dhi Architecture and Interiors

WIND CHISEL

Project Type - Industrial and Manufacturing

Location - Gokul Shirgaon, MIDC, Kolhapur

Scope - Architecture and Interior Design

Year - 2023 -2024

The architectural concept draws inspiration from the iconic silhouette of an aeroplane hangar, creating a bold, immersive homage to aviation. The front structure has been meticulously crafted to evoke an aircraft gracefully descending or parked within the hangar—a visual narrative capturing the poised dynamism of flight. This distinctive aesthetic pays tribute to Wind Chisel’s aerospace heritage while embodying a forward-thinking vision that harmonizes both innovation and industrial elegance. The design becomes a statement, celebrating the company’s pioneering spirit and anchoring it within a structure that both honours and elevates its aerospace legacy. Wind Chisel Pvt. Ltd., Kolhapur's pioneering manufacturer in the aerospace industry, represents an innovative fusion of architectural form and the dynamic essence of aerodynamics. As a trusted name in manufacturing, Wind Chisel Pvt. Ltd. has built a reputation for consistently delivering high-quality, reliable products with precision that surpasses the stringent demands of the aerospace sector. This esteemed client inspired us to design a space that mirrors their commitment to excellence and their industry’s spirit of innovation.

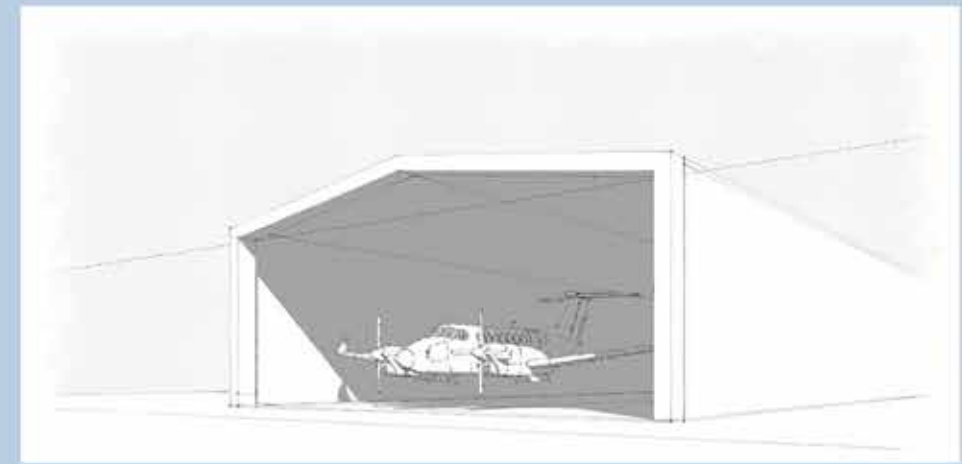

As a company specializing in aerospace components manufacturing, the idea of developing an aircraft hangar was explored to enhance structural innovation.

An aircraft hangar plays a pivotal role in the aviation industry, serving as a secure shelter for aircraft and related equipment. Whether accommodating a small private jet or a large commercial aircraft, hangars are essential for maintenance, storage, and protection from environmental factors. This hangar concept embodies structural stability while integrating elements of aerodynamic form, ensuring both functionality and aesthetic appeal.

The design not only prioritizes efficiency and durability but also reflects the principles of modern aviation architecture.

#### Form Development



a. Aircraft Hangar



b. Elevation development of the form



c. Elevation development considering the project requirements.



d. Development with a thought of material finishes

The scale and proportion of the hangar were carefully analyzed and integrated into the design to ensure both functionality and aesthetic coherence. This approach enhances the overall effectiveness and visual impact of the structure.







The interior design is a tribute to aerodynamic principles, with every element thoughtfully curated to embody the speed, precision, and sleek characteristics inherent in aviation. From the carefully chosen materials to the fluid layout and intricate detailing, each aspect of the space is designed to evoke a sense of movement and agility. This approach captures the essence of aerodynamics, seamlessly blending it with the industrial sophistication of the aerospace sector, creating an environment that inspires innovation and excellence.

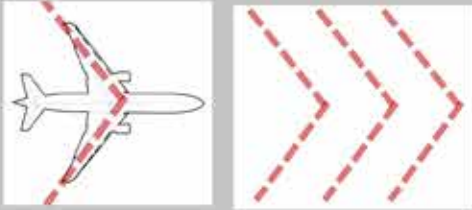

The arrow-shaped design, inspired by the aerodynamics of an airplane, is seamlessly reflected in the interiors. This thoughtful integration establishes a strong connection between the interior design and the core concept of the manufacturing unit, making the space visually and thematically relatable to aircraft components.



The Landscape was kept minimal in the front setback of the structure. A combination of plants, trees, shrubs, and groundcover was planned considering the maintenance requirements. A small water body with local shrubs and plants served the purpose of minimum maintenance.





# Where Architecture meets the Lens



**Ar. Prathmesh Bedekar**  
FAME SHUTTER

## FameShutter: Where Architecture Meets the Lens

In the ever-evolving realm of architectural photography and media production, one name stands out among the rest—FameShutter. A powerhouse of creativity and technical expertise, FameShutter has carved a niche for itself by seamlessly bridging the worlds of architecture and visual storytelling. Catering exclusively to leading architects, designers, and real estate developers, this media production house offers a refined perspective on spatial narratives, ensuring that every structure is presented in its most compelling light.

### The Power of Architectural Expertise in Photography

What sets FameShutter apart from the competition is its rare and invaluable advantage: an in-house architect. Prathmesh Bedekar, a licensed architect with a deep-rooted passion for visual storytelling, FameShutter doesn't just document spaces—it interprets them. This architectural expertise allows the team to comprehend a project beyond its aesthetic appeal, diving into its design philosophy, materiality, and spatial interplay.

Having an architect on board enhances their ability to capture the essence of a space with a trained eye, ensuring that the design intent remains intact in every frame. FameShutter understands the nuances of light, geometry, and composition in ways that traditional photographers may overlook. This results in images and videos that do more than just showcase a structure; they narrate its journey from concept to reality.

### A 360-Degree Media Solution for Architects

FameShutter provides a comprehensive suite of services tailored to the architectural community. From high-resolution photography and immersive videography to drone cinematography and virtual walkthroughs, the company ensures that every project is presented with cinematic precision. Their work goes beyond mere documentation—it amplifies the essence of architectural design, offering viewers an emotional connection to the space.

In a competitive industry where visual impact is paramount, FameShutter empowers architects and developers with content that elevates their portfolios, enhances client presentations, and strengthens their brand presence. Whether it's a modernist villa, a towering commercial complex, or a cultural institution, the team approaches each project with an understanding that architecture is more than a physical form—it is an experience.

### Bridging Creativity with Commercial Success

With an innate ability to blend artistic flair with marketing sensibilities, FameShutter is not just about capturing structures; it is about crafting compelling narratives that resonate with audiences. Their productions have been instrumental in securing investor confidence, attracting potential buyers, and winning prestigious architectural awards. By translating architectural brilliance into visually stunning media, FameShutter plays a crucial role in shaping how design is perceived and appreciated.

### The Future of Architectural Storytelling

As digital media continues to redefine the way architecture is consumed, FameShutter remains at the forefront of innovation. With advancements in virtual reality, interactive presentations, and AI-driven visual enhancements, the company is poised to set new benchmarks in architectural storytelling.

For architects and designers looking to immortalize their creations with unmatched precision and artistic depth, FameShutter is more than a media production house—it is a trusted partner in translating architectural vision into timeless visual art.











# Swami Niwas - A Shift in Vision



Ar. Snehal Mane- Paalkar &  
Ar. Sushant Paalkar  
S.P. ARCH STUDIO, NIPPANI



The original central staircase was reconfigured to enhance accessibility and flow. The ground floor, initially designed for stilt use, was transformed into a multifunctional space that now serves as an owner’s (astrologer’s) office and parking area.

The first floor, which was initially intended for two separate flats, was replanned as a 2BHK unit. This layout promotes a sense of unity and openness, allowing for seamless movement between living, dining, and kitchen areas. The design emphasizes natural light and ventilation, creating a comfortable and inviting atmosphere.



**Client Requirements:**

A Shift in Vision the project underwent a significant metamorphosis to meet the needs of its inhabitants, The decision to convert the apartment into a bungalow at stilt stage was driven by a desire for more space and a connection to the surrounding environment. The client sought a home that felt inviting and spacious, with a visual identity that resonated with the essence of a bungalow. The architects embraced this challenge, crafting a design that harmonizes modern aesthetics with traditional elements.



The house sits on approximately 40'X60' corner plot with North & east facing road. The trapezoidal corner spaces in plot utilised as a balcony space in each section. The original design was conceived as a dual-flat apartment, featuring a central staircase that effectively divided the space into two distinct living units at each floor plate.

This layout was functional for its intended purpose, providing separate access and privacy for each flat. However, as the project progressed, the client's vision evolved, necessitating a significant reimagining of the space and had a shift in a vision at stilt level.







### Stand out Features

One of the standout features of this bungalow is its opening. Maximum opening's are strategically placed at north and east to allow natural light without harsh glare so building does not gain heat. Each room is cherished with balcony and free size opening facing towards east and north.

The intricate terracotta jali work serves as a functional and decorative element, allowing natural light to filter through while providing privacy. This traditional technique is remained in a modern context, creating a dialogue between the past and the present. Making it a focal point of the design.

Complementing the terracotta, the use of locally sourced stone adds durability and a sense of grounding to the structure. The stone cladding not only enhances the aesthetic appeal but also ensures that the bungalow blends seamlessly with its natural surroundings.

### Conclusion

This architectural project exemplifies the power of adaptability and client collaboration in the design process. The transformation from an apartment to a bungalow not only meets the functional requirements of the client but also embodies a distinct visual identity that resonates with the essence of bungalow living.

For architects, this case study serves as a reminder of the importance of understanding client needs and the potential for innovative design solutions that can redefine spaces. By embracing change and prioritizing the user experience, architects can create homes that are not only functional but also deeply connected to the cultural and environmental context in which they exist.







THE  
KITCHEN



Furniture fittings that add beauty and practicality to living spaces for years.

THE KITCHEN  
671 E Vasantrajna Plaza, Shahupuri 3rd Lane, KOLHAPUR - 416001  
Aavinash Mehta: 9921315199 ; Nikkhil Shaha: 9623439399

Electrolux

The No.1 Swedish Home Appliance Brand



THE  
KITCHEN

Electrolux Exclusive Brand Store  
THE KITCHEN

No G3,G4,G5, Dwarka Heights, Plot No 819/1 E,  
Shahupuri 5th Ln, Kolhapur,  
Maharashtra 416001  
Contact no. - 7490909067

# ACE TECH BLUM AND ASTRAL INSTALLATION



Ar. Gautam & Ar. Geetanjali Naik  
GAUTAM GEETANJALI ARCH EXCEL CONSULTANTS

TEAM  
WORK IS  
DREAM  
WORK



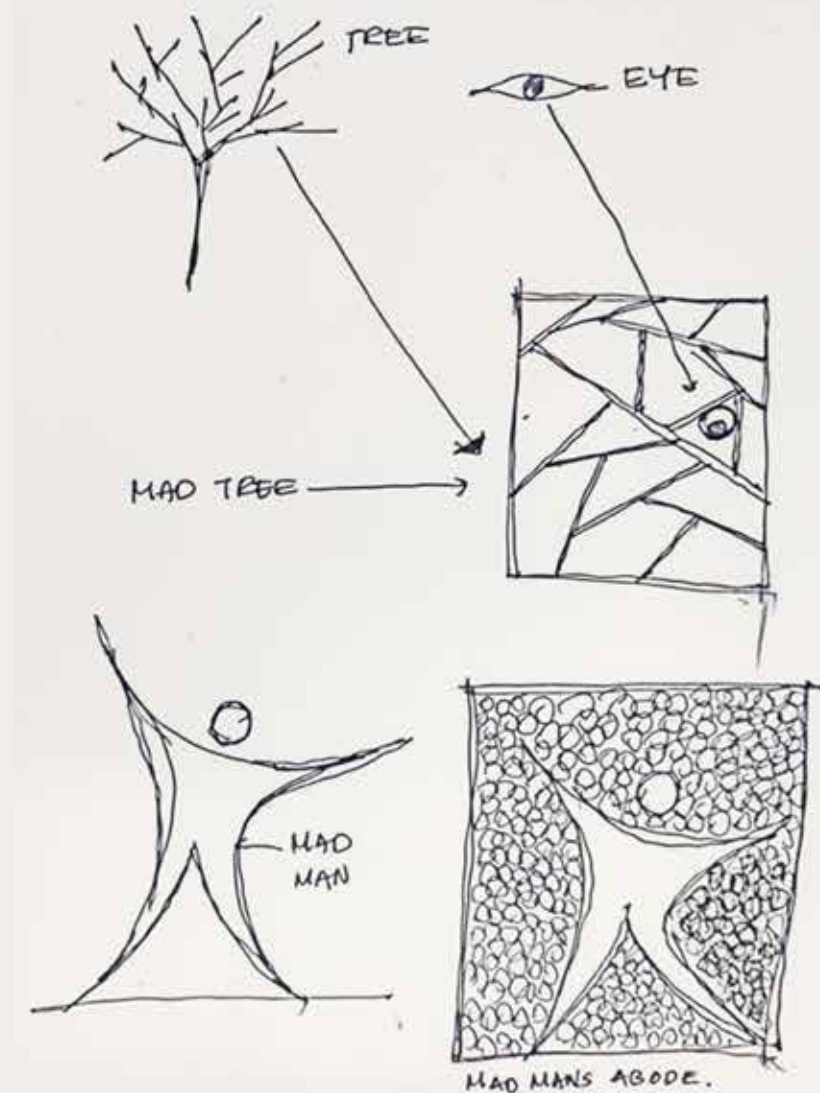

Last year was a double joy for GGAEC as we got to do two installations at ACE tech, and the brands were really special – BLUM and ASTRAL Also we were awarded for the same, which was received by our senior team member Ar Puru Vartak who has dedicatedly assisted us on these art installations- team work is dream work.

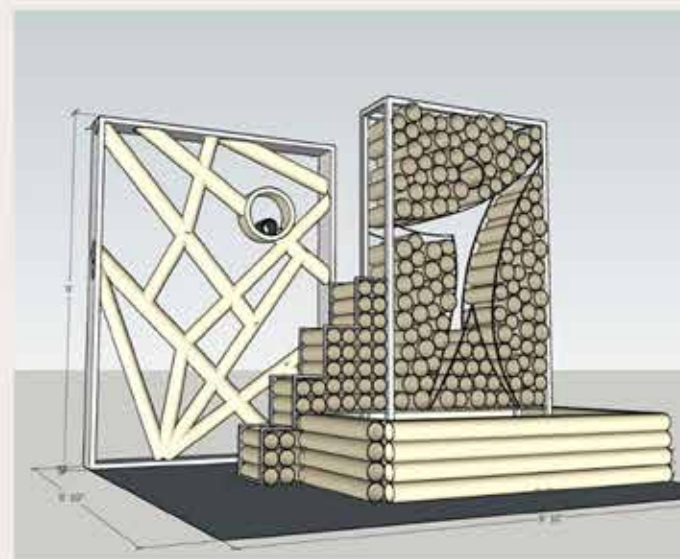

### Mad Man and Mad Tree

The brand Astral is a plumbing brand, And I chose sustainability and harmony. As a theme the story is of a mad man - A Man is insane in today's world as he is staying in the shadow of a large mad forest tree. A Mad tree in today's world is where everyone is running behind wealth. It is very rare to find Human beings who have dedicated their Life to live in harmony with nature, the concept is a dialogue between a mad man And a mad tree.

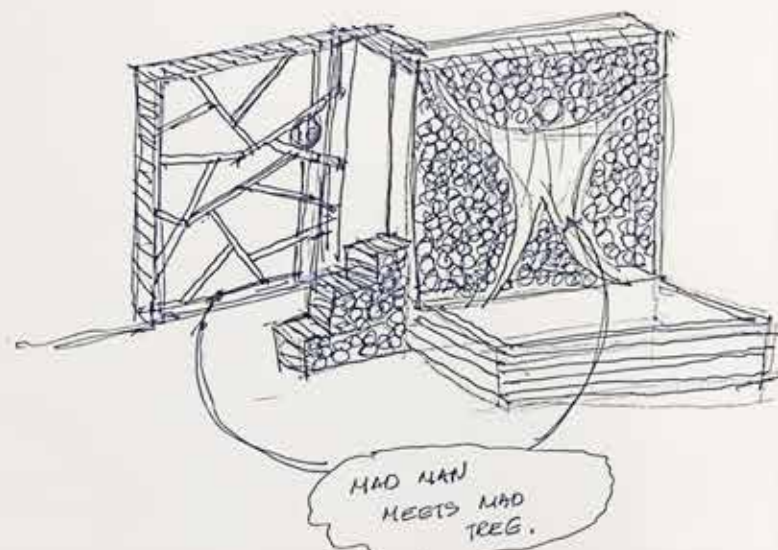

### The Mad Man and Mad Tree

In a world gone mad, a tree stood tall  
Un-watered yet flourishing beyond them all  
Defying norms it grew with reckless grace  
Its purpose giving, leaving space  
The mad man found solace in its shade,  
Living life unearthed yet serenely made  
Together they existed free from strife,  
Until the Mad man's peaceful end in the tree's  
embraced life.  
Both content in their eccentric sphere,  
A testament to life's beauty, unconfined and clear.

Ar. Gautam Naik



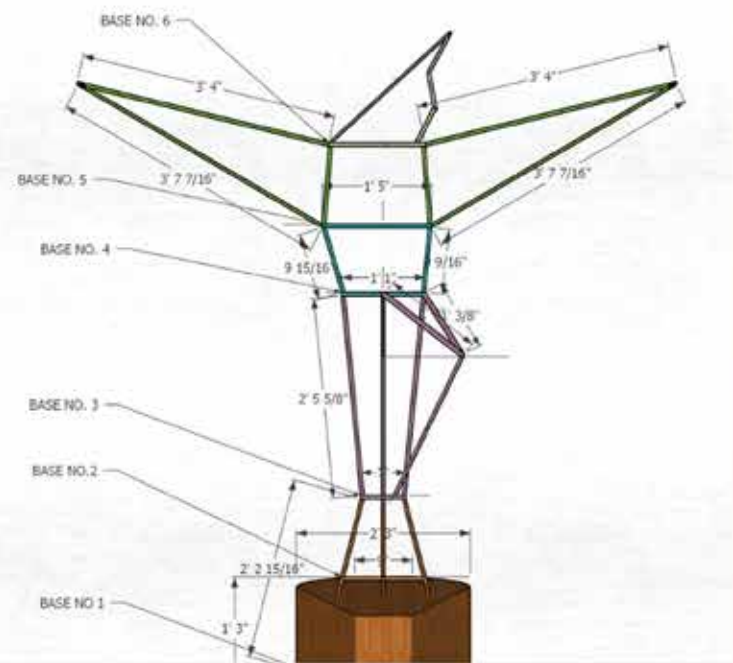

**Austrian Eagle does Indian yoga.** An Austrian Eagle jumps down the cliff to go into reincarnation, when it returns to its full Glory it meets an Indian mystic outside the cave, And then both of them exchange knowledge, The mystic teaches eagle yoga and the eagle Teaches mystic a ballet pose. It's a synergy Created between Indian designer And international brand- Blum. And thus the eagles journey.

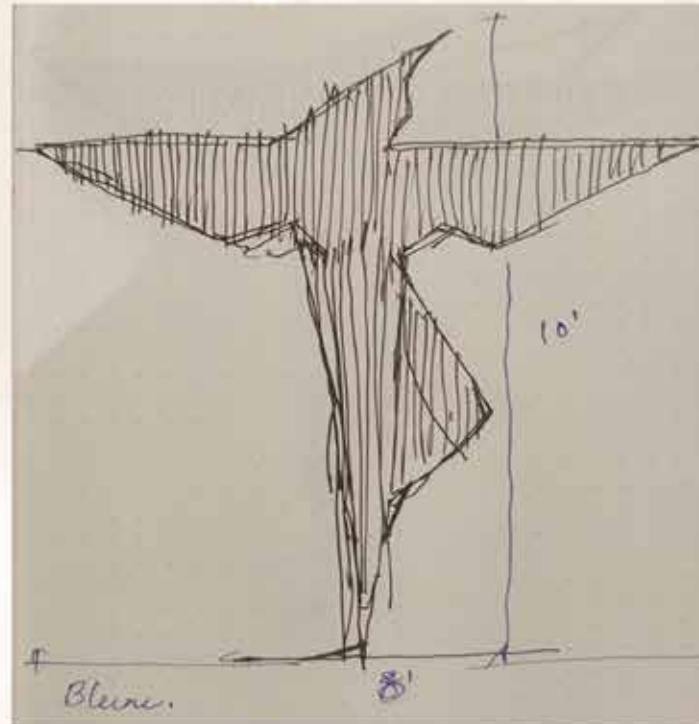

I am driven by wanderlust, inherently human,  
Seeking pleasures and mining the unknown treasures,  
Destined for serendipity, a gift from above,  
I embrace the journey, seeking answers with love.  
I don't question the path, but seek what's in store,  
Trusting the almighty to guide me evermore.  
— Ar. Gautam Naik

"Mining the treasures of the unknown" resonates deeply.  
It's a reminder that exploration and discovery are essential  
to human experience.



Every year during ACE Tech, BLUM Sponsors ACE street, And they invite selected 5 Architect to design And execute installations For them. In 2024 The chosen architects were Arzan Khambatta, Hafeez Contractor, Karan Desai and me. I feel Fortunate to be Consistently being Amongst the top league Architects of our country To create sculptures/ Installations and my Favorite topic is always An Eagle as its an Austrian Mascot and BLUM is Austrian.



And finally the eagle installation stands outside BLUM India Head quarters, Mumbai. And Astral Installation is neatly installed at their Rajkot Head office. The true beauty of any art installation is when it demands attention and attracts audience it becomes a focal Point.



The installations are Geometry in motion,  
A dialogue between light and perception.  
- Puru Vartak

The felicitation award for Blum and Astral installations was presented by Mrs. Gandhi and received by Ar. Puru Vartak from Design team of GGAEC.



# IMPULSE World Trends

presents



## The World-Class Lighting Experience

at



### Regent Experience Centre

Bhandarkar Road, Pune

Visit us to **Explore the Future of Lighting with The Expertise of Regent**

📍 2nd Floor, Abhijit Court, Bhandarkar Road, Pune - 411004. ☎ +91 883 077 8429



# E-seed's LATE SHRIKAR GARDE NATIONAL AWARD FOR EXCELLENCE IN SKETCHING.



Late Ar. Shrikar Garde

Late Shrikar Garde was a versatile personality, artist and a disciplined practising architect in Kolhapur. He had been promoting sketching activities amongst the students since long time. His passion for sketching inspired e-seed to hold a city level and national level competition amongst the students of architecture, that aims to create an awareness and importance about sketching. This year we could celebrate the World Architecture Day by conducting this competition in 11 cities on the same day and the same time. The activity started in 2023 with limited 2, 3 cities/ centres. But in 2024 it could become a first of its kind and made a pioneering history. This national level live sketching competition was only for the architecture students happened on 6th October (Sunday) between 9am to 11am at a time in 11 major cities which are New Delhi, Mumbai (with Navi Mumbai, Thane), Pune, Hyderabad, Indore, Lucknow, Baroda, Solapur, Kolhapur, Baramati, Satara, Nashik, Bijapur and Sangli. The venue selection liberty was extended to respective centres. The respective centres and the centre incharge handled the activity with protocols efficiently and the enthusiasm of the participants was just great. Approximate 1000 students participated and did live sketching at a time. The medium for sketching was only graphite pencil and sketching material was supposed to be carried by the participants. The A4 size paper was to be supplied by the e-seed. The centre incharges organized an on site jury process as per the given guidelines. A small lecture or a demonstration by the eminent juries were also organized by some centres.



FIRST PRIZE KOLHAPUR

E-seed offered a good budget of Rs. 25,000 to each centres that would take care the citywise prize money, stationary, refreshments and other miscellaneous expenditure.

The citywise prize money was,

First prize: Rs. 7000.

Second prize: Rs. 5000.

Third prize: certificate.

The winning entries were sent to Kolhapur for the selection of national award. This process happened at Ar. Milind Randive's office and the juries were Ar. Shirish Beri and Artist Rahul Repe. They scrutinized all entries and selected the national winners and their names are, National winner:  
First: Adhwaryu Kumbhar, Kolhapur.  
Second: Shantanu Mundalik, Baramati.  
Third: Aditya Mahajan, Mumbai.





SECOND PRIZE BARAMATI



THIRD PRIZE MUMBAI

The national winners will be invited to Kolhapur and will be awarded the trophy. The expenses against the travel and the local hospitality will be taken care by e-seed.

Overall the whole process was very exciting and it could proudly set an example in the entire country that how an alumni association of SPSMBHS COLLEGE OF ARCHITECTURE could help to promote the activities for upliftment of the fraternity.



## MOOD CREATION & AV SOLUTIONS



### OUR DEMO LOUNGE



## Home Automation & AV Experts Since 2008

### OUR EXPERTISE

- Home Automation System
- Digital Door Locks & Video Door Phones
- CCTV & Intrusion Alarm System
- Guest Room Management Solutions
- Home Theatre System
- Philips Lighting Products
- Motorised Blinds and Curtain Tracks
- WiFi and Intercom System

### OUR SISTER CONCERN TECHSPERTISE SOLUTIONS



**TECHSPERTISE SOLUTIONS**  
Home Automation & AV System Experts Since 2009

**Suyog Mahajan**  
+91 9923695272  
suyog@moodcreation.com

**Noah Rajendran**  
+91 95958 24848  
noah@moodcreation.com

Office Address:

305 & 510, West Avenue, Bremen Circle, Above Atithi Veg, Aundh, Pune - 411 007, MH., (India)

[www.moodcreation.com](http://www.moodcreation.com)



# Lonar Crater Conservation

## A Legacy of Preservation

The journey of conserving the Lonar Crater and its surrounding heritage began a few years ago around 2017 when a team of E-seedians architects, conservationists, and researchers visited the site in Maharashtra's Buldhana district. The crater, a unique geological marvel, is home to 32 temples, 17 monuments, 13 kundas, and 4 inscriptions—many of which were in a state of neglect. Recognizing the urgent need for conservation, e-seed took the initiative to document, study, and develop a comprehensive restoration plan.

The primary aim of this initiative was to conserve and restore the historical, cultural, and ecological significance of Lonar Crater. Our objectives included Preserving the unique geological and ecological environment of the crater. Restoring the architectural heritage of temples and monuments. Documenting historical and cultural narratives for future reference. Creating awareness and ensuring the longevity of this site as a natural and cultural treasure of Maharashtra and India. The conservation-documentation work was undertaken through a systematic approach: A team of architects, led by Ar. Shrikant Anpat, meticulously measured and documented the structures through detailed drawings and photographs.

Following the successful documentation and conservation efforts, the team focused on:

Publishing detailed reports on the restoration work. Engaging with local authorities to implement long-term protective measures. Conducting awareness programs and educational workshops for students, researchers, and conservation enthusiasts. Proposing the inclusion of Lonar Crater in heritage tourism circuits to ensure sustainable management and visibility.

**The Coffee Table Book Initiative :** To raise awareness and showcase the significance of Lonar Crater, ESEED Charitable Trust has taken the initiative to compile a Lonar Coffee Table Book. This book aims to acknowledge and highlight the crater's geological, ecological, and cultural prominence while serving as an informative and visually engaging record for the public, researchers, and policymakers.

Times of India published this coffee table book and first copy given to Hon Governor of Maharashtra Shri C P Radhakrishnan.

This book is available on Amazon , Flipcart and Airport book stalls. We request you to please buy this book from Eseeed trust Contact No.75882 83268.

Target Beneficiaries are: The general public, who will gain knowledge about Lonar's significance. Researchers and conservationists, who can use the documentation for further study. Government bodies and environmental organizations, who can take informed steps towards conservation.

We deeply acknowledge the support provided by the Archaeological Survey of India in carrying out the detailed survey of the Lonar crater, temples and monuments.

Special thanks to: Ar Geetanjali Naik, Ar. Pawan Rathi, Ar Akshay Salokhe and team who worked tirelessly on this initiative.

Through these efforts, we hope to ensure that Lonar Crater remains a cherished heritage site for generations to come. Conservation is not just about preserving the past—it is about securing a sustainable future.





# Morocco: Friends, Acquaintances, Memories, Laughter, and Discovery



No one asks if you're a desert person, do they? The desert, inhospitable and stark, not everyone's cup of tea (mint tea does win you over). Usually, I'm a very proactive traveler and do my research beforehand, but this time, I told myself it was an "eseed tour," so just let yourself be swept along with the frenzy! The dates had encroached upon me, I feverishly packed the previous night, and there was no going back now. Not even having read the itinerary, here I was, ready to embark on the greatest adventure with an unknown partner in crime (my roommate Mimlee, in whom I discovered a friendship along with an appreciation for a world view so diverse from my own). My head conjuring up images of mirages, the cold wind, the million stars, and the loneliness in which one can self-reflect!

At the Delhi airport, all my cares were blown to the wind amidst the chaos and warmth of bear hugs from fellow eseedians, it's clear as day, known to each other or not, we are friends bracing up for one hell of a ride.

Touchdown in Casablanca, surreal, buzzed with energy, straight into its heart with a visit to the Hassan II Mosque. The towering minaret made us feel like tiny specs in a vast world. We explored the Corniche and indulged in our first taste of Moroccan mint tea. "This is basically liquid gold," I thought as I drained my cup. By the end of the day, we were hooked and hungry for more!

The Capital Beckons, Rabat was elegant, like stepping into a storybook. The tree-lined streets and ocean views made for Instagram-worthy shots. The Hassan Tower and Mohammed V Mausoleum left us in awe. "Why don't we build anything this cool anymore?" I thought to myself.

Feeling Blue in the Best Way Possible? Only at Chefchaouen, the Blue City. Every hue imaginable—cobalt, azure, and periwinkle—you name it (architects actually can). "This place is like a Smurf village," I felt, as we wandered through its winding alleys. Our ulterior motive? Lots and lots of photos. Every door, every corner seemed like it was made for cameras.



Time Traveling Among Roman Ruins: Volubilis, A history buff's paradise, transported to another era. The mosaics told stories of gods and myths, while the crumbling columns whispered tales of a once-thriving city. It was humbling to think about how civilizations rise and fall, but leave behind echoes for us to discover. There is plenty to see albeit 50 percent of the site has been excavated to date, so much more remains undiscovered!







A maze of wonders awaits us at Fez, a sensory overload in the best way possible. The medina, a labyrinth of narrow alleys filled with vibrant souks and aromatic spices. The Chouara Tannery was fascinating and pungent (let's just say we were grateful for the mint sprigs handed out at the entrance). Holding our breath, we marveled at the craftsmanship on display.



Late Evening, dirt tracking in a 4x4, a gut-wrenching adventure as we squealed into the night, deeper into the Sahara. Immersed in its ethereal beauty, the Merzouga Desert Camp. Not knowing what to expect, was a surprise!! We were shown to our sleeping tent, and it was a bedroom-style double bed in a marquee tent—talk about glamping! Our Berber hosts, were natives who live a nomadic life. Don't assume them to be ignorant; they are humble and happy with what they have, there's a lesson or two right there.

Winding Through the Heart of Morocco, Ifrane, "Little Switzerland," we took a pause to breathe in the fresh smell of conifers, the cool breeze, the European-inspired architecture and natural beauty. Then came Midelt, picturesque reliefs cut out the horizon, giving off an impression of calm and serenity, slowing giving way to the Ziz Valley, its lush palm groves and the winding Ziz River, which looked like "Western movie" at places.



A childlike happiness washed over me as I found myself around the campfire, tapping to the melodious drums and songs about Berber life. We sang (badly), laughed (loudly), and feasted our eyes on a vast and beautiful clear sky, studded with more stars than you could imagine. It's one of the world's largest dark sky reserves, with little light pollution, allowing us to spot, pretty much every constellation.

We all began counting the shooting stars into the wee hours (I won, by the way)! Sunrise over the Erg Chebbi Dunes was unforgettable—a palette of pinks and oranges, as we watched the golden dunes stretched endlessly before us! Gripping for dear life, till our knuckles were white, we swayed, clinging on camel backs, our transport to our buses. No words, just a feeling—one that I never thought I'd never experience (The soreness proved it was all real)





The bus Snaking along the Todra Gorge and Dades Valley a prehistoric scene out of Jurassic park, that took our breath away. Towering canyons (higher than the Empire State Building in New York) and a lush oasis, created by the River Todra carving its way through limestone for centuries. Silent witnesses to the history and resilience of its Berber inhabitants, frozen in time. "Can you imagine living here centuries ago?"

Hours on the Road but Never a Dull Moment: We rubbed our eyes, is it a mirage? Skoura palmeraie loomed—a lush oasis, emerging out of nothing in such an arid area. Ancient adobe fortresses, gave us an idea of what life three to four centuries ago.



A go-to spot for Hollywood, with films like Gladiator, The Mummy, The Jewel of the Nile, and even Lawrence of Arabia. Here, Daenerys Targaryen (Game of Thrones fame) was seen freeing slaves in the arid and dramatic cities Have you ever known "eseeedians" to be far behind? (Ask those who went on the tour for more tidbits about our very own production!)

Come dawn, we find ourselves marching Through "the Door of the Desert", Ouarzazate, on the trade route, nestled amidst the Atlas Mountains, Ounila Valley, a UNESCO World Heritage site of the fortified ksar (a kind of traditional pre-Saharan dwelling).It felt otherworldly,



All too soon our last pit stop, Casablanca. Conversations with broken French (deep colonial influences) & Arabic and laughter over our last cups of mint tea. We reflected on everything Morocco had given us: laughter, awe, connection, and a (con)fused version of belly dance (rummaging for video evidence). Above all, the locals, who have lived there for centuries and have gained world recognition for their traditional friendliness and cultural richness! We soaked in the music and the olive oil in khobz accompanied by jben (marinated olives), honey baghrir pancakes, and more tagines. We even replaced the traditional "smile" for the cameras with "taaaginnnee!" (Truth be told, by now, we didn't want to see or smell another tagine).



Our journey ended where it began—but this time with heavier hearts (and heavier suitcases). As our plane took off, I looked out at Morocco fading into the distance—a country so warm, a reminder that kindness transcends language or prosperity.

All those with whom I shared these moments, each is a memory I deeply cherish!

Our salute to the organizers (past life army generals who can literally tame the beast), no one does it better! So pack your bags (preferably not last minute like myself), and go, see life differently, you'll always find a home within yourself. A journey always stays with you long after you have left!





# UNVEIL A SYMPHONY OF LUXURY WITH CES INDIA

Indulge in Opulence: Your Sanctuary of Air Conditioning Extravagance

Expert Curation | Tailored Brilliance | Impeccable Aftercare

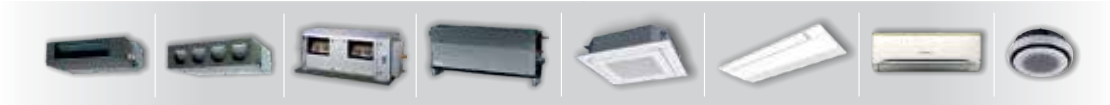

Brands Available



**Shri. Abhishek Pradeep Jadhav**  
(B.E. Mechanical, PGDBM) (Member of ISHRAE, R.A.T.A India)

Immerse yourself in a world of exclusivity with our curated offerings: Air-Conditioning, Ventilation, Process Cooling, Clean Room Infrastructure Design and Build Solutions, AMC Services.  
At CES India, we craft environments that transcend the ordinary into the extraordinary.



**Regd. Office** - 202, Kalyan Complex, 426, New Mangalwar Peth, Pune.  
**Shop Address** - 8, C/o Chintamani Co-op.Hsg.Society, Narpatgir Chowk, Somwar Peth, Pune.  
**8983160773 / 7709845682**



